

ORDINANCE NO. 1384

AN ORDINANCE ANNEXING THE FOLLOWING UNINCORPORATED AREA OF BAY COUNTY WHICH IS CONTIGUOUS TO THE CITY OF PANAMA CITY BEACH, FLORIDA, UPON PETITION OF THE OWNER OF SAID PROPERTY LOCATED AT 19942 PANAMA CITY BEACH PARKWAY, ON THE NORTH SIDE OF PANAMA CITY BEACH PARKWAY, WEST OF THE INTERSECTION OF PANAMA CITY BEACH PARKWAY AND MALAGA; SAID PARCEL CONTAINING .833 ACRES MORE OR LESS; REDEFINING THE BOUNDARY LINES OF THE CITY; PROVIDING THAT THIS ORDINANCE SHALL TAKE EFFECT IMMEDIATELY UPON PASSAGE.

WHEREAS, ReliantSouth Construction Group, Inc., owner of real property in an unincorporated area of Bay County which is contiguous to this City, have filed a petition on the 5th day of April, 2016, praying that said real property, being more particularly described below, be annexed to this City, and

WHEREAS, the City Council of this City has determined that the petition bears the signatures of all the owners of the property in the area proposed to be annexed, and

WHEREAS, Notice of Voluntary Annexation for this property has been published in the Panama City News-Herald once a week for two (2) consecutive weeks prior to this date, the same being a newspaper of general circulation in this City.

NOW, THEREFORE, BE IT ENACTED BY THE PEOPLE OF THE CITY OF PANAMA CITY BEACH, FLORIDA:

Section 1. It is hereby annexed and made a part of the City of Panama City Beach, Florida, the following described lands in Bay County, Florida, to-wit:

SEE EXHIBIT "A" ATTACHED HERETO

Section 2. The boundary lines of the City of Panama City Beach, Florida, are redefined to include therein said tract of land.

Section 3. A map of the area to be annexed is attached.

Section 4. This ordinance shall take effect immediately upon passage.

PASSED, APPROVED AND ADOPTED at the regular meeting of the City Council of the City of Panama City Beach, Florida, this 23rd day of June, 2016.

Mike Thomas
Mike Thomas, Mayor

ATTEST:

Diane B Fowler
Diane Fowler, City Clerk

EXAMINED AND APPROVED by me this 23rd day of June, 2016.

Mike Thomas
Mike Thomas, Mayor

PUBLISHED in the Panama City News-Herald on the 1st and 8th days of June, 2016.

POSTED on pcb.gov.com on the 28th day of June, 2016.

Diane B Fowler
Diane Fowler, City Clerk

ATTACHMENT TO ORDINANCE NO. 1384

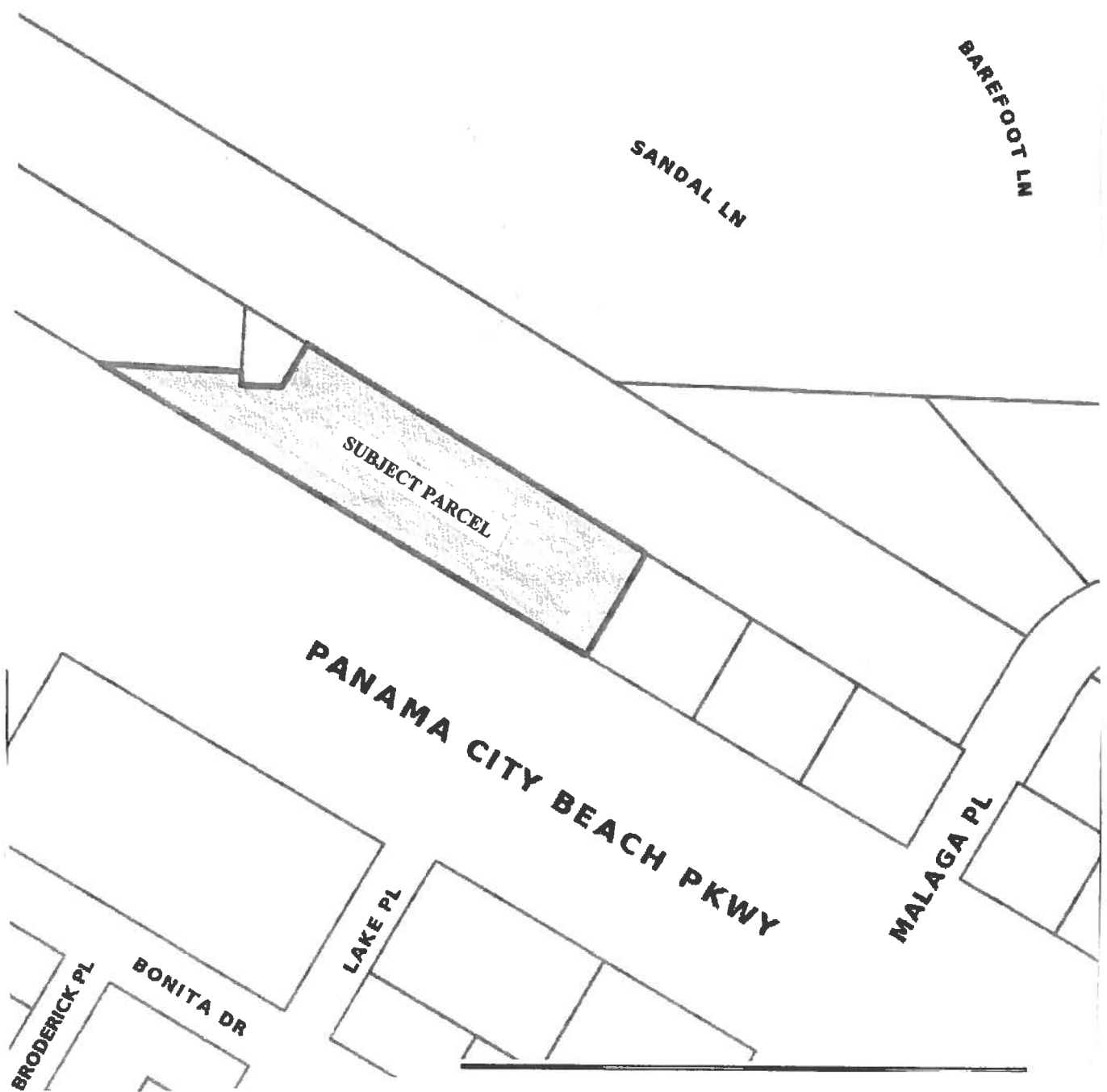

EXHIBIT A

ORDINANCE NO. 1384

COMMENCE AT THE NORTHWEST CORNER OF SECTION 11, TOWNSHIP 3 SOUTH, RANGE 17 WEST, BAY COUNTY, FLORIDA; THENCE S 01°31'20" W ALONG THE WEST LINE OF SECTION 11 FOR 1319.74 FEET; THENCE S 87°53'31" E FOR 476.22 FEET TO A ST. JOE PAPER COMPANY MONUMENT ON THE NORTH R/W LINE OF PANAMA CITY BEACH PARKWAY (200' R/W) AND THE POINT OF BEGINNING; THENCE S 87°53'31" E, 115.47 FEET; THENCE S 02°06'32" W, 10.00 FEET; THENCE S 87°53'52" E, 34.75 FEET; THENCE N 29°48'34" E, 37.77 FEET TO THE SOUTH R/W LINE OF 100 FOOT GULF POWER COMPANY EASEMENT; THENCE S 60°17'25" E ALONG SAID R/W LINE FOR 319.61 FEET; THENCE S 29°42'42" W FOR 99.34 FEET TO THE NORTH R/W LINE OF PANAMA CITY BEACH PARKWAY (200' R/W); THENCE N 60°11'11" W ALONG SAID R/W LINE 457.43 FEET TO THE POINT OF BEGINNING, CONTAINING 0.8326 ACRES MORE OR LESS.