

**RESOLUTION 18-48**

A RESOLUTION OF THE CITY OF PANAMA CITY BEACH, FLORIDA, APPROVING AN AGREEMENT WITH PPLT FARMINGTON INC. C/O PLAYWORX PLAYSETS, LLC IN THE AMOUNT OF \$69,590.39 FOR THE PURCHASE AND INSTALLATION OF PLAYGROUND EQUIPMENT FOR THE FRANK BROWN PARK UNDER THE PALMS PLAYGROUND.

**BE IT RESOLVED** that the appropriate officers of the City are authorized but not required to accept and deliver on behalf of the City that certain Agreement between the City and PPLT Farmington Inc. c/o Playworx Playsets, LLC relating to the purchase and installation of playground equipment for the Frank Brown Park Under the Palms Playground in the basic amount of Sixty Nine Thousand Five Hundred Ninety Dollars and Thirty Nine Cents (\$69,590.39), in substantially the form attached and presented to the Council today, with such changes, insertions or omissions as may be approved by the City Manager and whose execution shall be conclusive evidence of such approval.

**THIS RESOLUTION** shall be effective immediately upon passage.

**PASSED** in regular session this 25<sup>th</sup> day of January, 2018.

**CITY OF PANAMA CITY BEACH**

By: 

Mike Thomas, Mayor

**ATTEST:**

  
Jo Smith, City Clerk

**CITY OF PANAMA CITY BEACH  
 BID TABULATION**

Bidder	Address	Information	Price
JA Dawson	PO Box 1178 Pelham, AL 35124	Under the Palms Playground	<b>\$88,875.00</b>
Playworx Playsets	810 Holly Ridge Canton, GA 30115	Under the Palms Playground	<b>\$69,590.39</b>
Rep Services	581 Technology Park Ste 1009 Lake Mary, FL 32746	Under the Palms Playground	<b>\$119340.00</b>
Playmore West	10271 Deer Run Farms Rd Fort Meyers, FL 33966	Under the Palms Playground	<b>\$107,285.00</b>
Advanced Recreational Concepts	3125 Skyway Circle Melbourne, FL 32934	Under the Palms Playground	<b>\$141,151.00</b>

**PROPOSAL FORM**

TO: City of Panama City Beach, Florida

SUBMITTED: 1/11, 2018.

**Frank Brown Park Under the Palms Playground**

The Undersigned, as Bidder, hereby declares that they have examined the proposed specifications and informed themselves fully in regard to all conditions pertaining to the equipment to be supplied.

The Bidder proposes and agrees, if this proposal is accepted, to contract with the City of Panama City Beach for the lump sum price listed, to furnish all labor, materials and supplies to install free and clear the Frank Brown Park Under the Palms Playground in complete accord with the described and reasonably intended requirements of this request for proposals and the specifications submitted by Bidder to satisfaction of the City, with a definite understanding that no additional money will be allowed for any corrections or additions. Payment in full will be made to the Bidder within 30 days of delivery and completion of installation acceptable to the City. Bidder further agrees hereby to complete the Frank Brown Park Under the Palms Playground install by **March 31, 2018**, with liquidated damages thereafter of \$200.00 per day.

Purchase will be made under terms and conditions specified by the City in its form of a Purchase Order. If a deposit is required, it must be specified below. Final payment, in readily available funds, will be made upon acceptance by the City of strictly conforming goods after delivery and install. Strict adherence to design and specifications submitted by the Bidder and accepted by the City in writing will be required.

**ADDENDUM ACKNOWLEDGMENT:** (Only if addendums have been provided). I, the undersigned bidder, hereby acknowledge receipt of the following addenda: Addendum No. \_\_\_ Addendum No. \_\_\_.

**SUMMARY DESCRIPTION OF THE UNIT AND LUMP SUM PRICE:**

Summary description of the proposed Under the Palms Playground:  
The Under the Palms Playground, designed for fun for children of all abilities, ages 5-12, consists of over (24) connected play events and ( ) stand-alone play features. In addition, we are including a complimentary Bonus interactive play feature, Biba!

Note: A detailed description not exceeding 10 pages, will include a photograph/sketch/drawing of the playground and a written description of the warranty of equipment meeting the minimum requirements of the bid specs must be attached to this Proposal. Please include a list of the total number of Play Events on the Main Play Feature. Remember, there must be a minimum of 24 Play Events.

Lump sum price for the Frank Brown Park Under the Palms Playground: \$ 69,590.39

Specify terms of any deposit or write "none required": NONE REQUIRED

Name of SUPPLIER: PPLT Farmington Inc. / Playworx Playsets, LLC

ADDRESS: 810 Holly Ridge CITY: Canton STATE: GA ZIP: 30115

EMAIL ADDRESS: dave@playworx.com PHONE: (404) 427-5270

SIGNATURE -- (Confirming all information above is correct) [Signature]

Print Name: Elizabeth Haman and Print Title Assistant office Manager

# Under the Palms

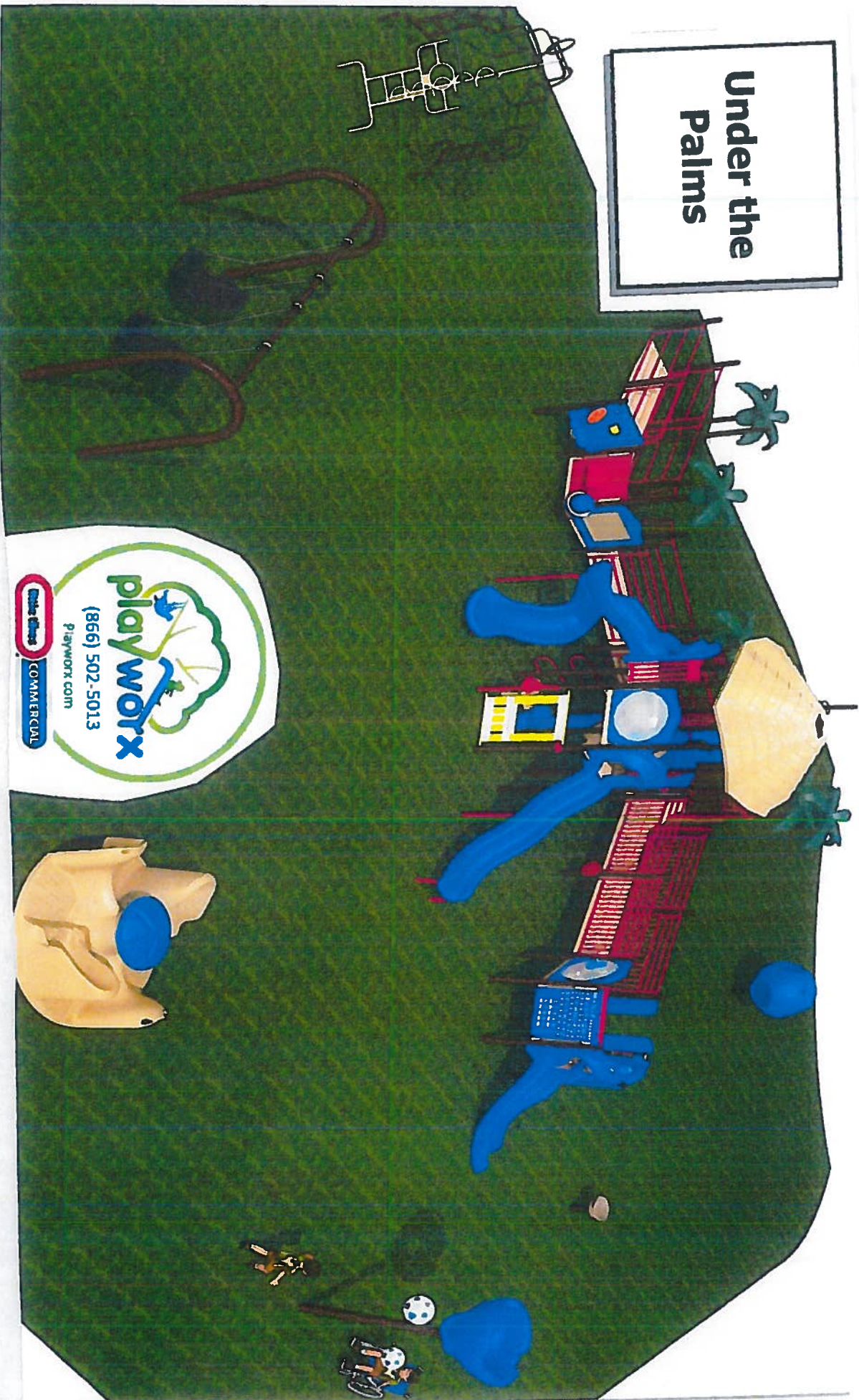

**playworx**  
Playworx.com  
(866) 502-5013

Circle Kines COMMERCIAL

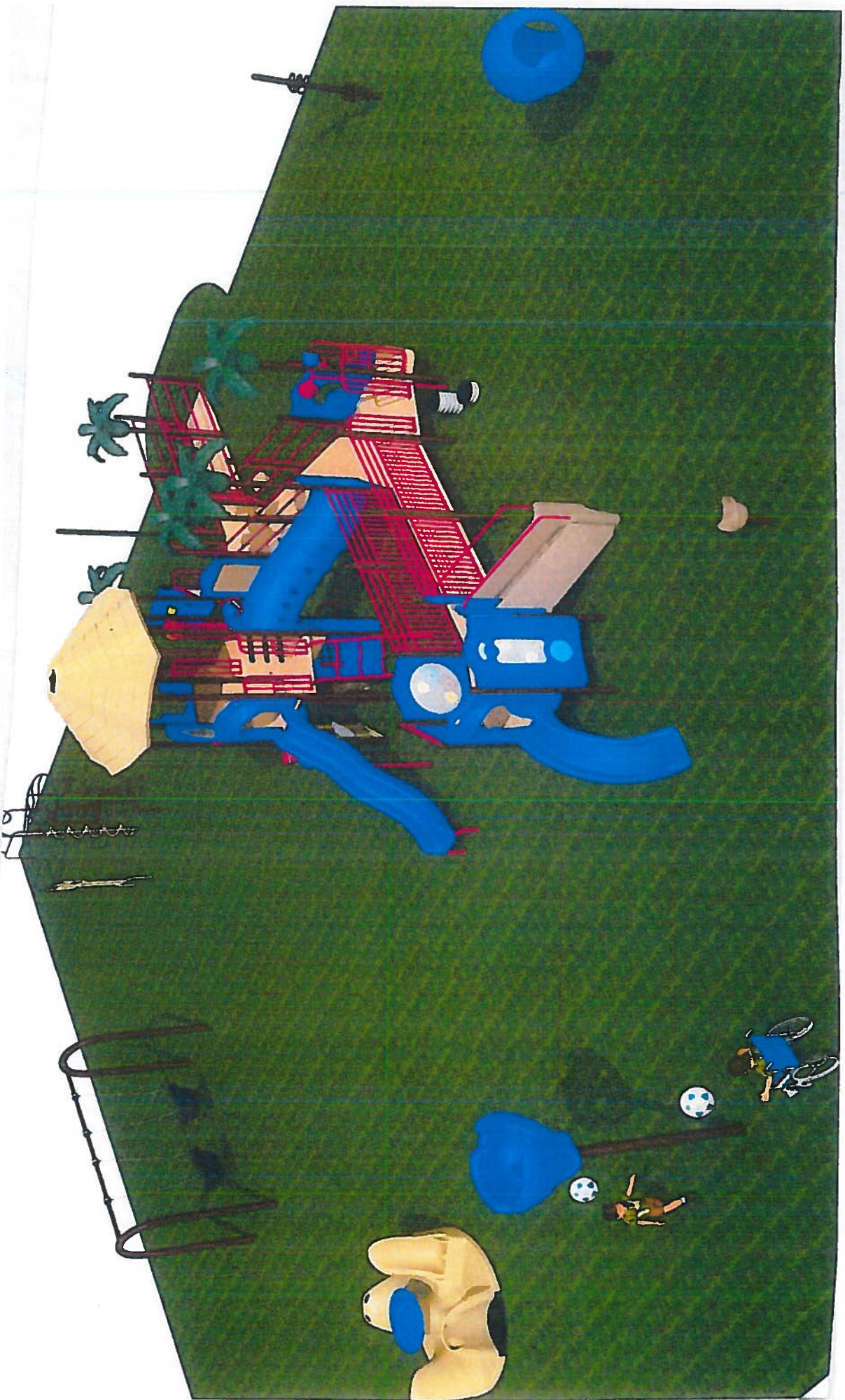

2-5 yrs  6-12 yrs  12-12 yrs  13+ yrs

- The Americans with Disabilities Act (ADA) may require that you make your park and/or playground accessible when viewed in the eye. ADA applies to you.
- For playground equipment to be considered accessible, accessible surfacing must be utilized in applicable areas.
- Although a particular playground design may not meet the proposed Access Board Regulations in regards to the appropriate number of ground level events, the actual playground may be in compliance when considering the following:
- All heights are measured from top of ground cover.
- Fall absorbing ground cover is required under and around all play equipment.
- The minimum recommended fall zone around the entire play structure is shown. This zone is to be free of tripping and collision hazards (i.e. rocks, trees, border, etc.).
- All post lengths are identified by text showing the post lengths, i.e. 96 represents a 96 inch post.
- Not all equipment may be appropriate for all children. Supervision is required.

AGE GROUP	5-12
ELEVATED PLAY ACTIVITIES - TOTAL	14
ELEVATED PLAY ACTIVITIES ACCESSIBLE BY TRANSFER	0
ELEVATED PLAY ACTIVITIES ACCESSIBLE BY RAMP	10
ELEVATED PLAY ACTIVITIES ACCESSIBLE BY LIFT	4
GROUND LEVEL ACTIVITY TYPE	11
GROUND LEVEL ACTIVITY QUANTITY	12

Child Capacity: 87

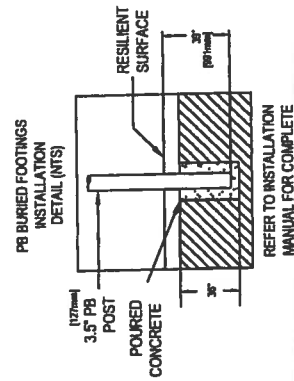
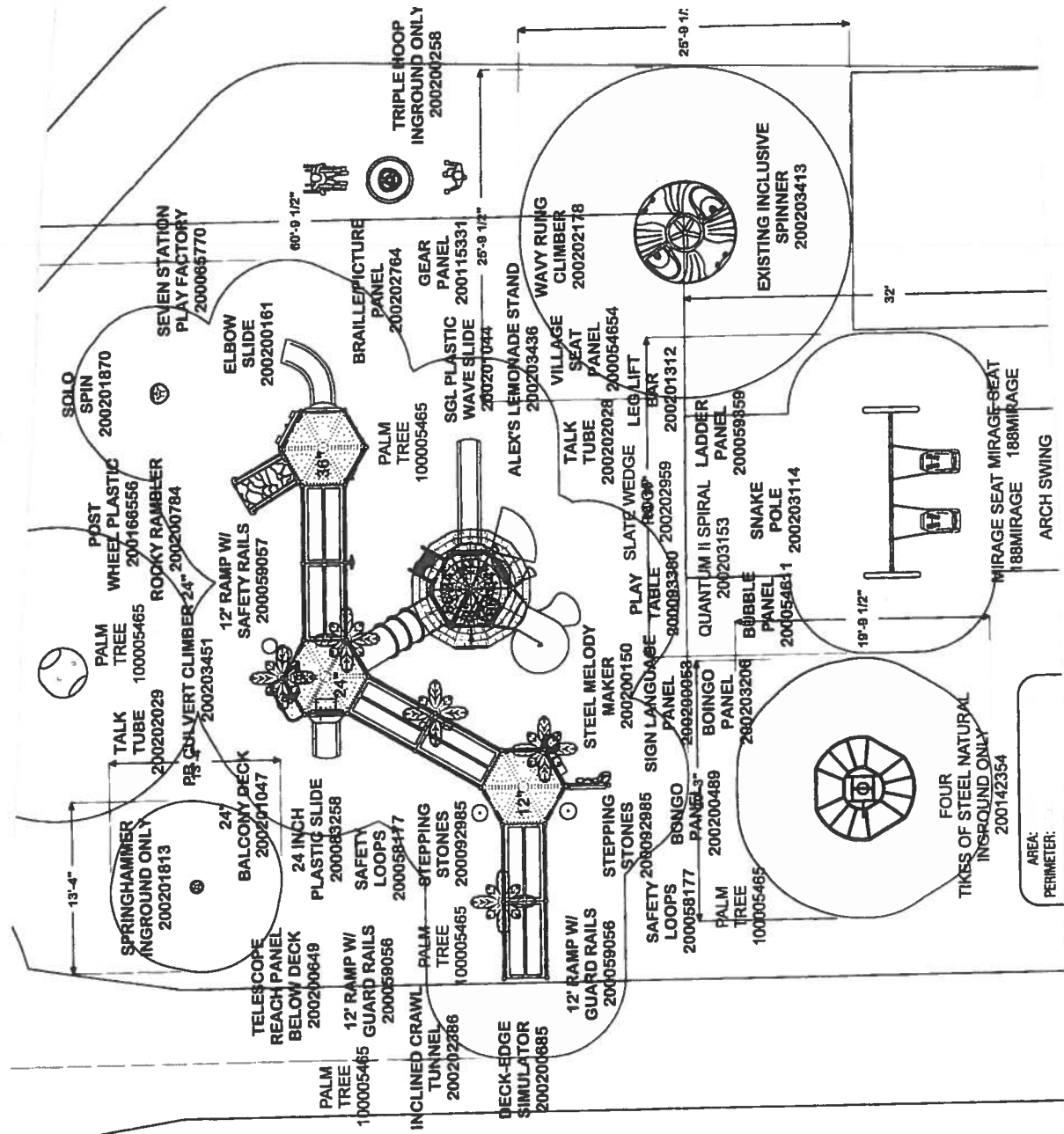

REFER TO INSTALLATION MANUAL FOR COMPLETE

**Play Events Specified in RFP**

Wilder Slide II Single Spiral

Store Panel

Ashiko and Djembe

Calabazo Panel

(2) Hex Pods

(3) Ramps

Rumble Slide

Crow's Nest

Wave Climber

Ridge Climber

Driver's Panel

Swerve Zip

Language Panel

Thunder Ring Half Panel

Stego Climber

Seat and Table for Two

Roof

Tunnel Up Crawl Tube

Observation Station

Talk Tubes

Rung Kick Plate

Hand Cyclor

**PPLT Equivalent Play Events**

8ft. Quantum II Spiral

Alex's Lemonade Stand

Boingo Panel

Bongo Panel

(3) Stepping Stones

(3) Ramps

Single Wide Slide

Balcony Panel

Culvert Climber

Rocky Rambler

7 Station Play Factory

Elbow Slide

Braille Picture Panel

Gear Panel

Wavy Rung

Village Seat Panel with Play Table

Roof

Incline Crawl Tube

Bubble Panel

Talk Tubes

Ladder Panel

Steering Wheel

(4) Palm Trees

**Stand Alone Specified in RFP**

Arch Swing

Ball Roller

Egg Seat

8 ft. Climber

Bidder's Choice

Bidder's Choice

**\*\*\*Additional Play Feature\*\*\***

**PPLT Equivalent Stand Alone**

Arch Swing

Triple Hoop (Promotes upper body strength, as well as coordination, and is a great introduction to the game of basketball for children of all abilities)

Wobble Sphere

Tikes of Steel

Solo Spinner

Spring Hammer

**\*\*\*Biba (See attached description of the interactive fun the Biba provides)\*\*\***



---

**Subject: U.S. Consumer Product Safety Commission (CPSC), ASTM F 1487  
Safety Performance Specification Standard, IPEMA Certification and  
The Americans with Disabilities Act**

PlayPower LT Ferrisburgh, Inc. is committed to providing challenging and safe playground equipment for children of all ages around the world. We fully support the CPSC's Handbook for Public Playground Safety guidelines and to the best of our professional knowledge, PlayPower LT currently meets and/or exceeds all pertinent and applicable recommendations of the guidelines.

With the concern for the children's safety, PlayPower LT is fully committed to support the continued development of the ASTM F1487 Standard Consumer Safety Performance Specification for Playground Equipment for Public Use.

In the interest of public playground safety, IPEMA (International Play Equipment Manufacturers Association) provides a 3<sup>rd</sup> Party Certification program whereby a designated independent laboratory validates a manufacturer's certification of compliance to the ASTM F1487 Standard. PlayPower LT's products have been validated by IPEMA and are certified to ASTM F1487.

In addition to complying with the guidelines and standards, PlayPower LT designs its play equipment and playground layouts to the requirements of the ADA (Americans with Disabilities) Play Area Rules.



Playgrounds Fun & Easy!

## Product Warranty Statement

Revised December 1, 2010

Subject to the limitations, exclusions and provisions set out herein PlayPower LT Farmington, Inc. warrants its products, under normal use and proper maintenance, as follows:

**Limited One-Year Warranty** - On all products against failure due to defects in material and workmanship.

**Limited 160-Year Warranty** - On all aluminum posts, steel posts, stainless steel hardware and KidBuilders® steel clamps against structural failure due to corrosion or deterioration from exposure to weather or caused by defects in materials and workmanship.

**Limited 50-Year Warranty** - On the impact attenuation performance of LandSoft® Rubber Mulch safety surfacing when maintained to Little Tikes Commercial specifications.

**Limited 15-Year Warranty** - On all rigid main play structure plastic, steel, and vinyl coated components against structural failure due to corrosion or deterioration from exposure to weather or caused by defects in materials and workmanship.

**Limited 10-Year Warranty** - On all ShadeBuilders® steel frames against failure due to corrosion, deterioration or faulty workmanship.

**Limited 10-Year Warranty** - On LandSoft® Rubber Mulch color steadfastness.

**Limited 8-Year Warranty** - On the impact attenuation performance and appearance of LandSoft Synthetic Turf safety surfacing when maintained to Little Tikes Commercial specifications.

**Limited 5-Year Warranty** - On all ShadeBuilders fabric due to rot, UV deterioration (shades of red are limited to 3 years) or defective workmanship.

**Limited 5-Year Warranty** - On all coated steel rope cables and Matrix® steel cables against structural failure due to corrosion or deterioration from exposure to weather or caused by defects in materials and workmanship.

**Limited 5-Year Warranty** - On all Clever Climbers™ polyethylene slides, enclosures, main structure, decks, and plastic components against failure caused by defects in materials and workmanship.

**Limited 3-Year Warranty** - On KidTikes®, KidTimbers® Border Panels, Playground Sculptures and all KidRiders® products (excluding spring assemblies) against structural failure due to defects in materials and workmanship.

**Limited 1-Year Warranty** - On all Learning Lab™ Sensory Tables and Tot Tree plastic components against failure caused by defects in materials and workmanship.

**Limited 1-year Warranty** - against structural failure due to defects in materials or workmanship for all products and components that are not specifically listed above, including, without limitation, all moving parts, such as swing bearings, chains, trolleys, springs, flexible climbers, and play panel mechanisms.

### LIMITATIONS, EXCLUSIONS AND ADMINISTRATION

1. The warranty periods set out above shall begin on the date products are shipped from Seller's facility. Repaired and/or replaced products are warranted through the expiration of the original warranty period.
2. Seller's Limited Warranty extends only to the original purchaser/end user of products from Seller or Seller's authorized reseller ("Original Purchaser"). It is not transferable to anyone who subsequently purchases products from the Original Purchaser.



**Playwork Playsets**

**REFERENCES**

**WITH LIST OF SIMILAR PROJECTS**



Entity	Description	Date	Reference	Projects	Contact Information
Gwinnett County Schools	Provided and installed well over \$1,000,000 in playgrounds over the past 10 years	2006 to current	Michael Swafford Operations Manager	Various new schools and existing schools	437 Old Peachtree Rd NW Savannah GA 30024 678-301-6288 Mike_Swafford@Gwinnettk12.ga.us
Cherokee County Schools	Provided and installed well over \$1,000,000 in playgrounds over the past 10 years	2008 to current	Randy Evans Facilities Director	Various new schools and existing schools	200 Mountain Brook Ct Canton GA 30115 770-721-8441 randy.evans@cherokee.k12.ga.us
Dekalb county Schools	Provided and installed well over \$1,000,000 in playgrounds over the past 10 years	2006 to current	Elizabeth Epstein Design Manager	Various new schools and existing schools	1780 Montreal Road Tucker GA 30084 678-676-1516 Elizabeth_Epstein@dekalb.k12.ga.us
Savannah Chatham County Schools	Provided and installed approximately \$1,000,000 in playgrounds	2015 to Incurrent	Timothy Sparks	Various new schools and existing schools	208 Bull Street Rm 316 Savannah GA 31401 678-672-9890 Timothy.Sparks@parsons.com

City of Acworth	Designed, provided and installed 2 new playgrounds \$475,000	2013 And 2016	James Albright	Cauble and Logan Farm Park	4762 Logan Rd Acworth GA 30101 770-917-1234 jalbright@acworthga.org
Athens Clarke County	Designed, provided and installed new custom playground \$800,00 plus various projects over the last 10 years	2016	Keith Sanders Splot Project Administrator	World of Wonders Whit Davis Athens, GA	801 S College Ave SU 101 Athens GA 30601 706-613-8052 Keith.Sanders@athensclarkecounty.com



**Playgrounds Fun & Easy!™**  
CERTIFICATE

OF  
FACTORY INSTALLATION CERTIFICATION

PLAYWORXPLAYSETS, LLC  
Woodstock, Georgia

has successfully completed the requirements to be recognized as a  
factory certified installer

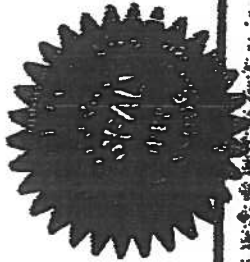

January 2009

*Trammy Guggenbeigh*  
Vice President, Operations



## CITY OF PANAMA CITY BEACH AGENDA ITEM SUMMARY

**1. DEPARTMENT MAKING REQUEST/NAME:**

Parks and Recreation

**2. MEETING DATE:**

January 25, 2018

**3. REQUESTED MOTION/ACTION:**

Staff's recommendation is to approve the most responsive low bid from PPLT Farmington Inc. C/O Playworx Playsets, LLC in the amount of \$69,590.39.

**4. AGENDA**

PRESENTATION   
PUBLIC HEARING   
CONSENT   
REGULAR

**5. IS THIS ITEM BUDGETED (IF APPLICABLE)?** YES  NO  N/A   
BUDGET AMENDMENT OR N/A

DETAILED BUDGET AMENDMENT ATTACHED YES  NO  N/A

**6. BACKGROUND: (WHY IS THE ACTION NECESSARY, WHAT GOAL WILL BE ACHIEVED)**

On January 15, 2018, Staff received five (5) sealed bids for the Frank Brown Park Under the Palms Playground Project for Ages 5 to 12. PPLT Farmington Inc. C/O Playworx Playsets, LLC was the most responsive low bid in the amount of \$69,590.39. Please see attachment.

In Attachment B of the Bid Packet you will find the planned Frank Brown Park Under the Palms Playground location. With City Council approval, this Under the Palms Playground project is planned to be completed by March 31, 2018. This Playground project is Handicap Accessible.

After this project is complete, handicap accessible playground surfacing will be installed.

All Playground projects for 2018 have been budgeted in the adopted 2017-2018 Budget.

The City Attorney, City Manager and Finance Director have reviewed and approve the recommendation to award PPLT Farmington Inc. C/O Playworx Playsets, LLC the Frank Brown Park Under the Palms Playground Project bid in the amount of \$69,590.39.